

ANTENNAS CUSTOM ANTENNA RADOME ENCLOSURE

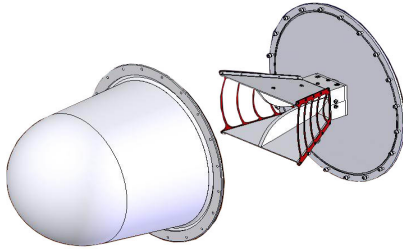

ETS-Lindgren's Custom Antenna Radome Enclosure offers a weatherproof environment for our most popular horn antennas. Each radome housing includes the radome, mounting brackets, a mounting plate, and feedthrough connectors.

Radomes are made from vacuum formed Acrylonitrile Styrene Acrylate (ASA) material, which is ideal for this application. The relative dielectric constant changes from 3.0 at 800 MHz to 2.70 at 20 GHz. The loss tangent is also low, from 0.023 at 800 MHz to 0.0087 at 20 GHz.

Additionally, ASA is very hydrophobic as opposed to the hydroscopic materials such as ABS or fiberglass. This is important given the high relative permittivity of water (epsilon = 80). The material also has excellent UV stability and meets UL standard 94 V-0 flammability resistance.

CUSTOM RADOME ENCLOSURE

- Utilizes ETS-Lindgren's RFCD Door Technology
 - Low Dielectric Constant
 - Hydrophobic Properties
 - UV Stability
 - Resistance to Flammability
- Mounting Plate Available for These Antennas:
 - Model 3115 Horn
 - Model 3116C Horn
 - Model 3117 Horn
 - Model 3164-05 Horn

Performance Specifications

Mechanical	
RF Connectors	Type N (f)
Physical	
Height	35.79 cm (14.09 in)
Diameter	41.91 cm (16.50 in)
Weight	4.5 kg (10 lbs)